

Items needed for installation:

- 2 1/2" long construction screws
- Wood shims
- Level
- Phillips Tip Screwdriver

Directions for a single base cabinet and stretcher:

1. Level base cabinet with wood shims and attach to wall with 2 1/2" construction screws.
2. Note front side of stretcher, set stretcher piece on base cabinet and align. Ensure stretcher is flush with back of Vanity. Use 4 ea. 1 1/4" screws (supplied in plastic bag) to fasten stretcher to top of Vanity base in pre-drilled holes.
3. Adjust the height of the stretcher by removing the four dowel pins and raising outer frame to desired height. Re-install 4 dowel pins.
4. Note: Outer band height of stretcher can be adjusted from a flush height with inner band to 3" above inner band.
5. Cabinet is now ready for countertop and plumbing installation. If installing a D'Vontz Marble Slab apply a spot of clear silicone adhesive on each corner of stretcher top. Carefully set Marble Vanity Top into place making sure Vanity Top is centered left to right and flush with back of stretcher.
6. Note: If door gap needs adjustment, even gap by adjusting the adjustment screws on door hinges.

Directions for multiple base cabinets with stretcher:

1. Remove cabinets from packaging and arrange together in the correct order of installation.
2. Carefully match cabinet fronts together and clamp using soft jawed clamps. Pre-drill two 1/8" holes through the inside of one cabinet and insert 1-14" screws through the holes securing the cabinets together.

*Your new cabinet has been left un-drilled for hardware. With the many options for knobs and pulls, this decision has been left up to you as far as type and location. If you have questions about hardware locations, please contact Customer Service and we will be happy to assist.

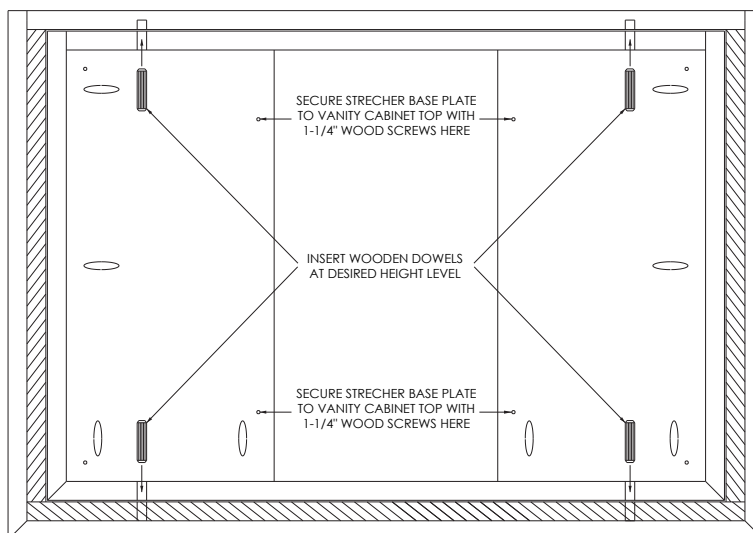

Any questions with your installation, please call Customer Service at (877) 322-3600. We will be happy to assist you.

www.dvontz.com

Copyright 2005, D'Vontz L.L.C. All Rights Reserved